

Super High Density BGA Heat Sinks

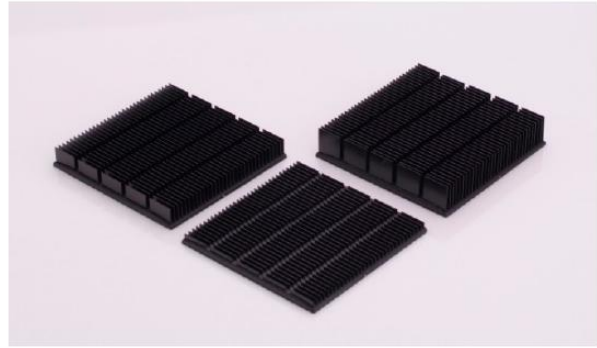
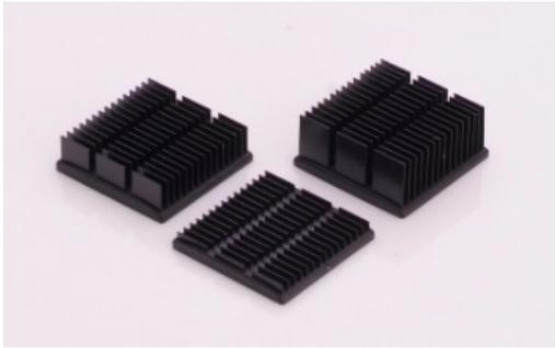

Performance

Chipset Size LxW(mm)	Part Number	Thermal Resistance: θ_{SA} at 200LFM		
		H=3mm	H=6mm	H=9mm
19 x 19	LT19001-XX20ZA	13.90	8.34	6.42
25 x 25	LT25001-XX20ZA	9.00	5.36	4.55
27 x 27	LT27001-XX20ZA	8.78	4.89	4.05
30 x 30	LT30001-XX20ZA	8.52	5.10	4.32
35 x 35	LT35001-XX20ZA	7.33	3.79	3.45
37 x 37	LT37001-XX20ZA	6.85	3.88	3.24
40 x 40	LT40001-XX20ZA	6.42	3.48	2.33

Model : LT19001-XX20ZA



Heat Sink

Specification

- 1. Material : Al 1070
- 2. Dimension :
 - Foot print : 19 x 19mm
 - Height : 9、6、3mm
 - Base (thickness) : 2.0mm

- 3. Finish: Black Anodize

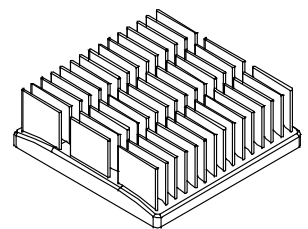
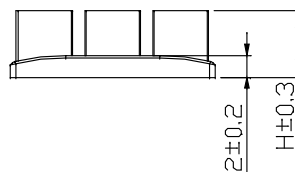
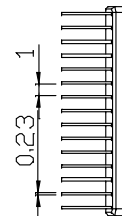
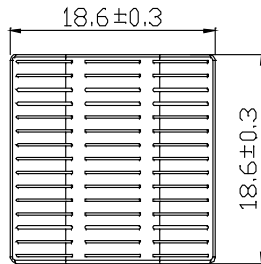

Performance

Heat Source (LxW)	12x12
-------------------	-------

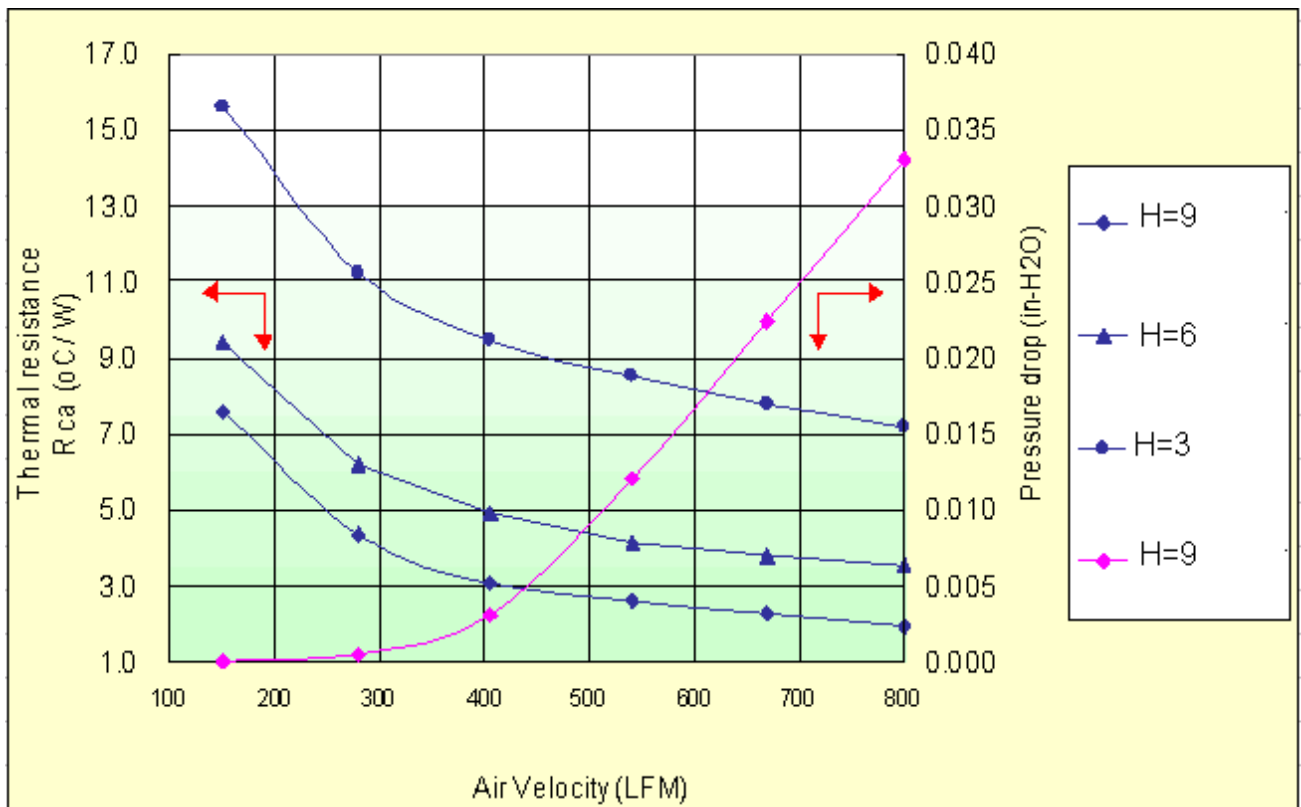

Model : LT25001-XX20ZA



Heat Sink



Specification

- 1. Material : Al 1070
- 2. Dimension :
 - Foot print : 25 x 25mm
 - Height : 9、6、3 mm
 - Base (thickness) : 2.0mm

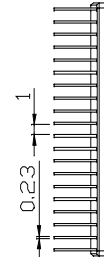
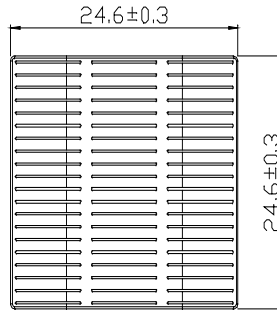

- 3. Finish: Black Anodize

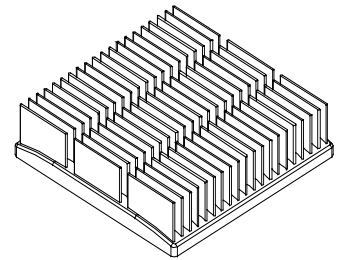
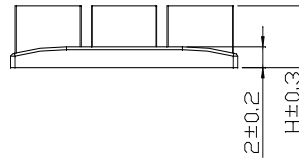

Performance

Heat Source (LxW)	12x12
-------------------	-------

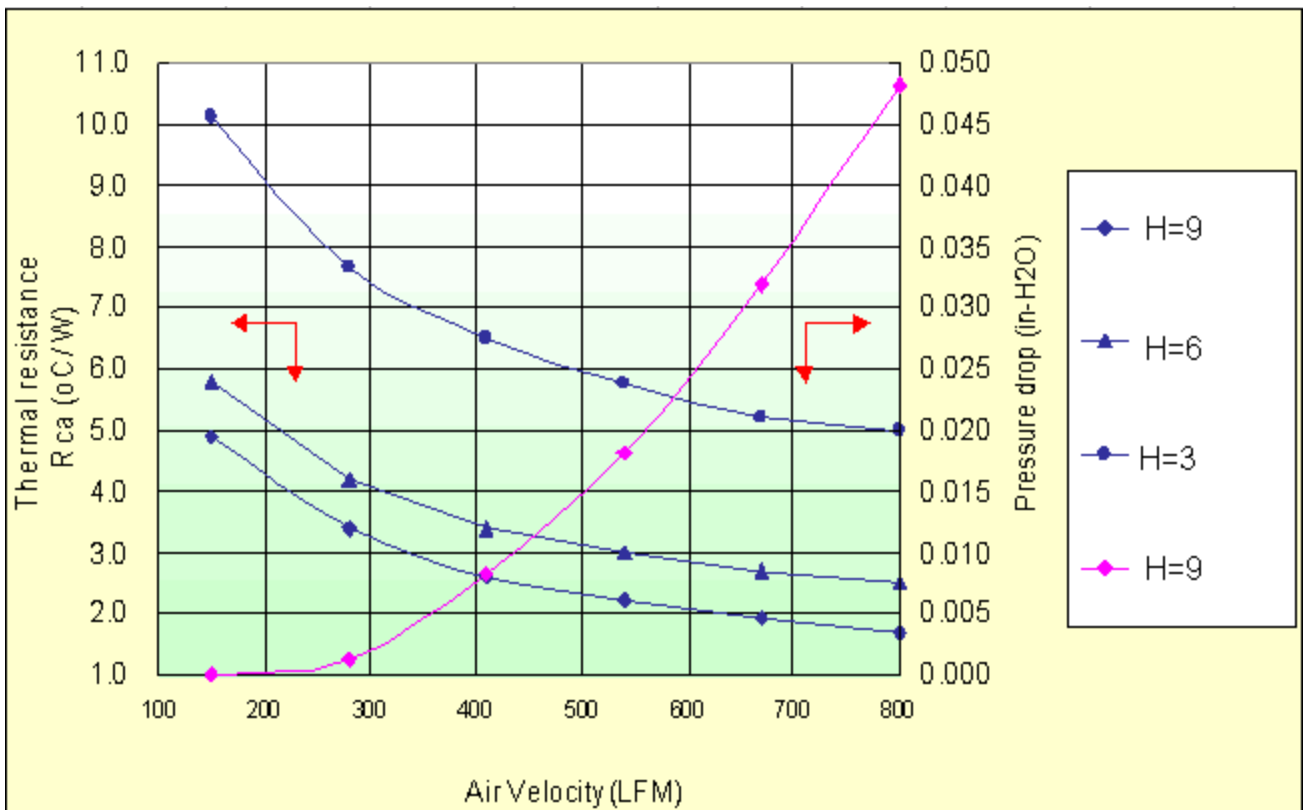

Model : LT27001-XX20ZA



Heat Sink



Specification

- 1. Material : Al 1070
- 2. Dimension :
 Foot print : 27 x 27mm
 Height : 9、6、3 mm
 Base (thickness) : 2.0mm

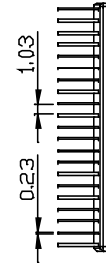
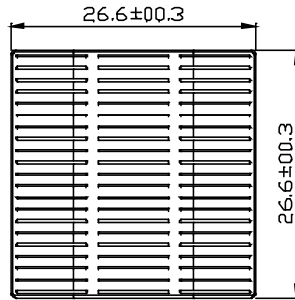

- 3. Finish: Black Anodize

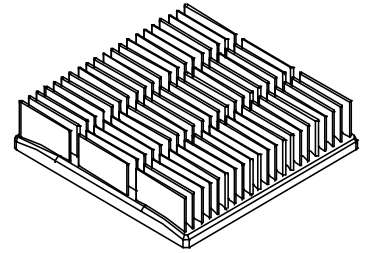
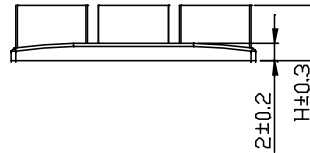

Performance

Heat Source (LxW)	12x12
-------------------	-------

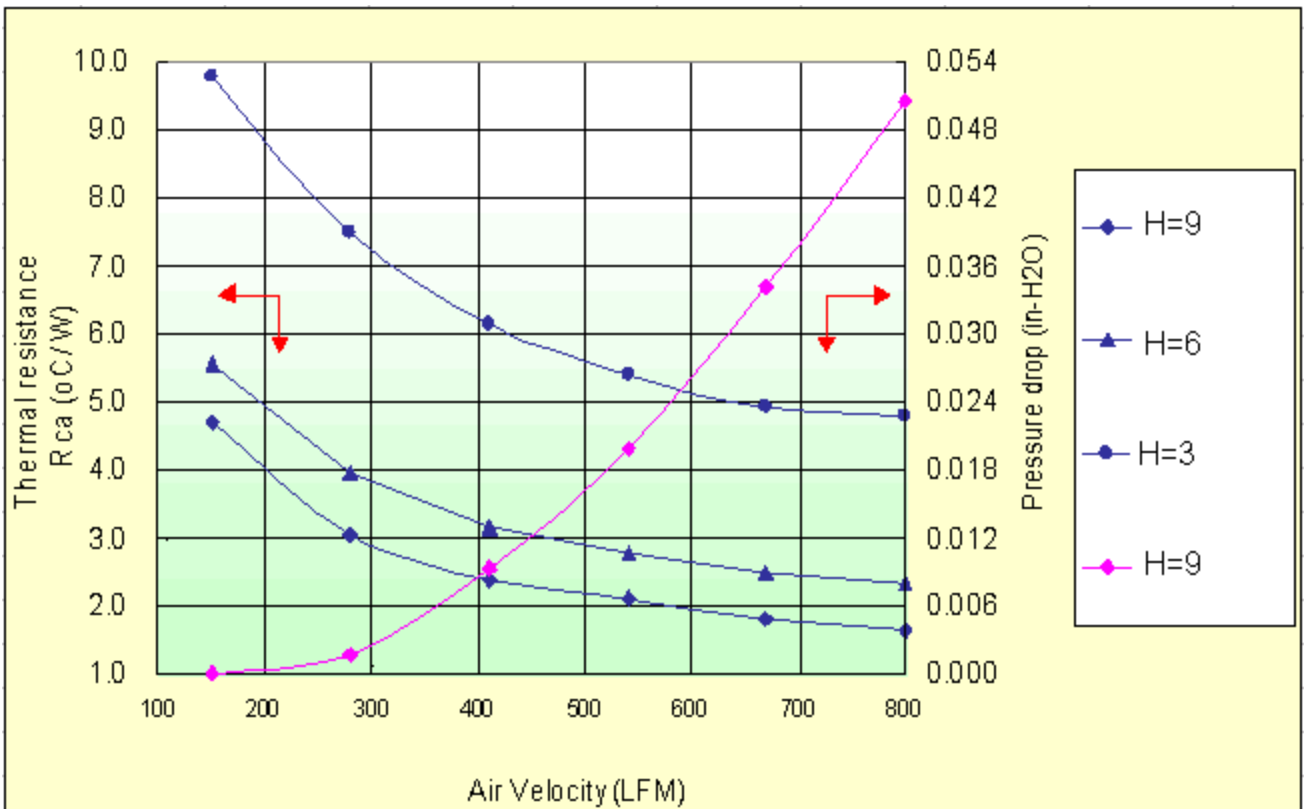

Model : LT30001-XX20ZA



Heat Sink



Specification

- 1. Material : Al 1070
- 2. Dimension :
 - Foot print : 29.6 x 29.6mm
 - Height : 9、6、3 mm
 - Base (thickness) : 2.0mm

- 3. Finish: Black Anodize

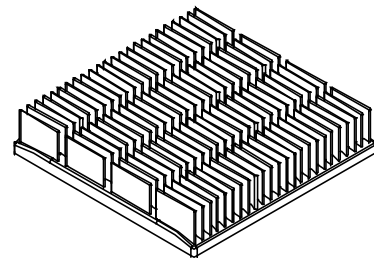
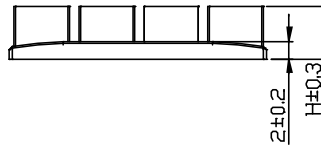
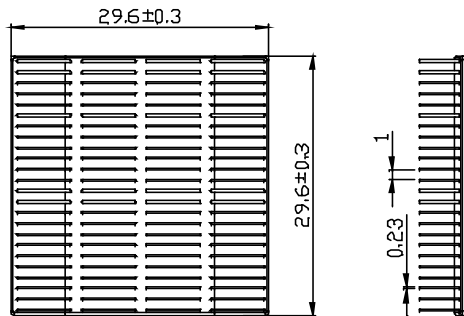

Performance

Heat Source (LxW)	12x12
-------------------	-------

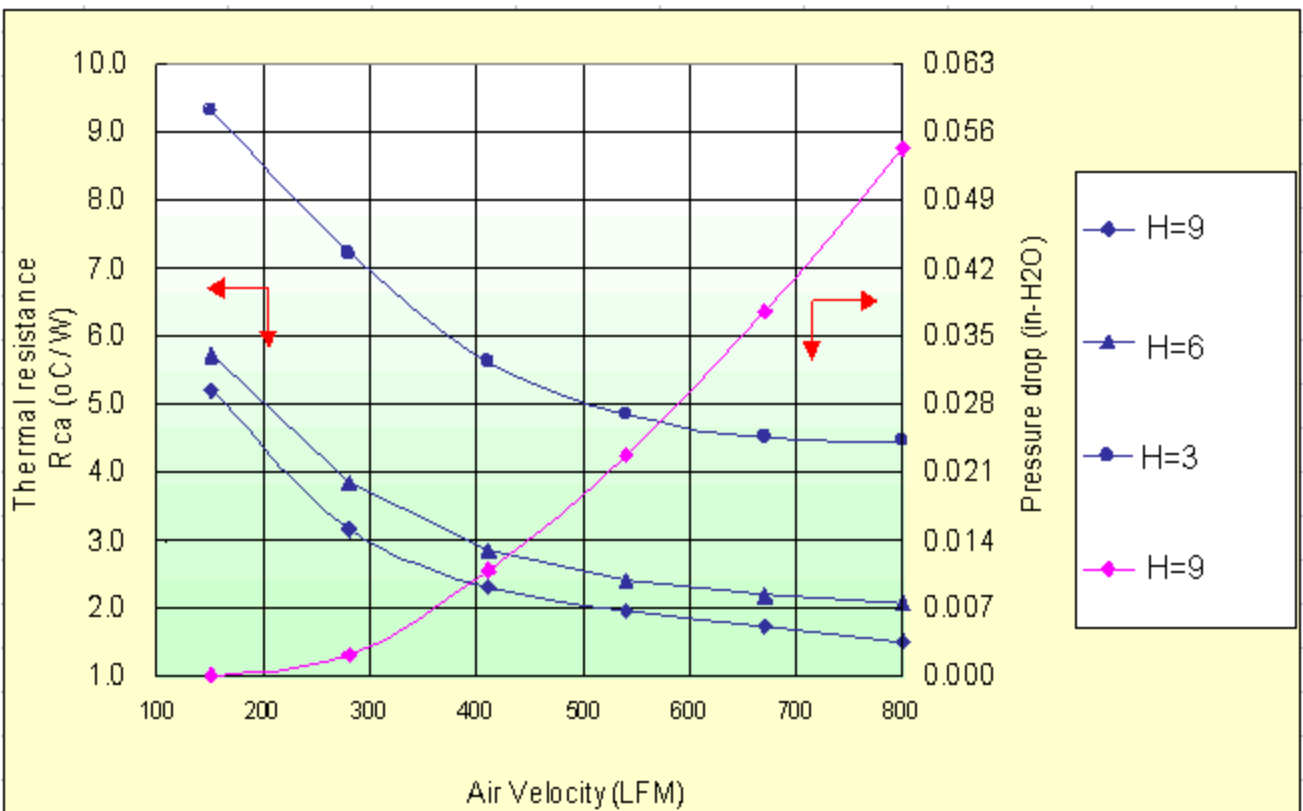

Model : LT35001-XX20ZA



Heat Sink



Specification

- 1. Material : Al 1070
- 2. Dimension :
 - Foot print : 35 x 35 mm
 - Height : 9、6、3mm
 - Base (thickness) : 2.0mm
- 3. Finish: Black Anodize

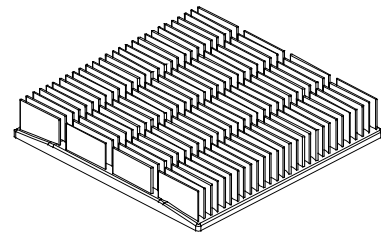
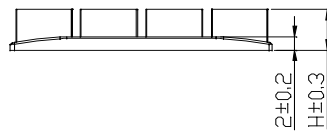
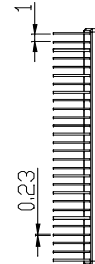
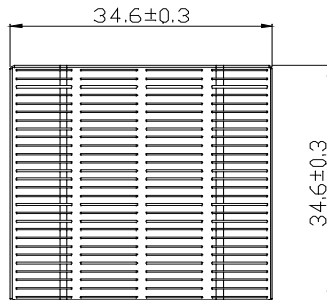

Performance

Heat Source (LxW)	12x12
-------------------	-------

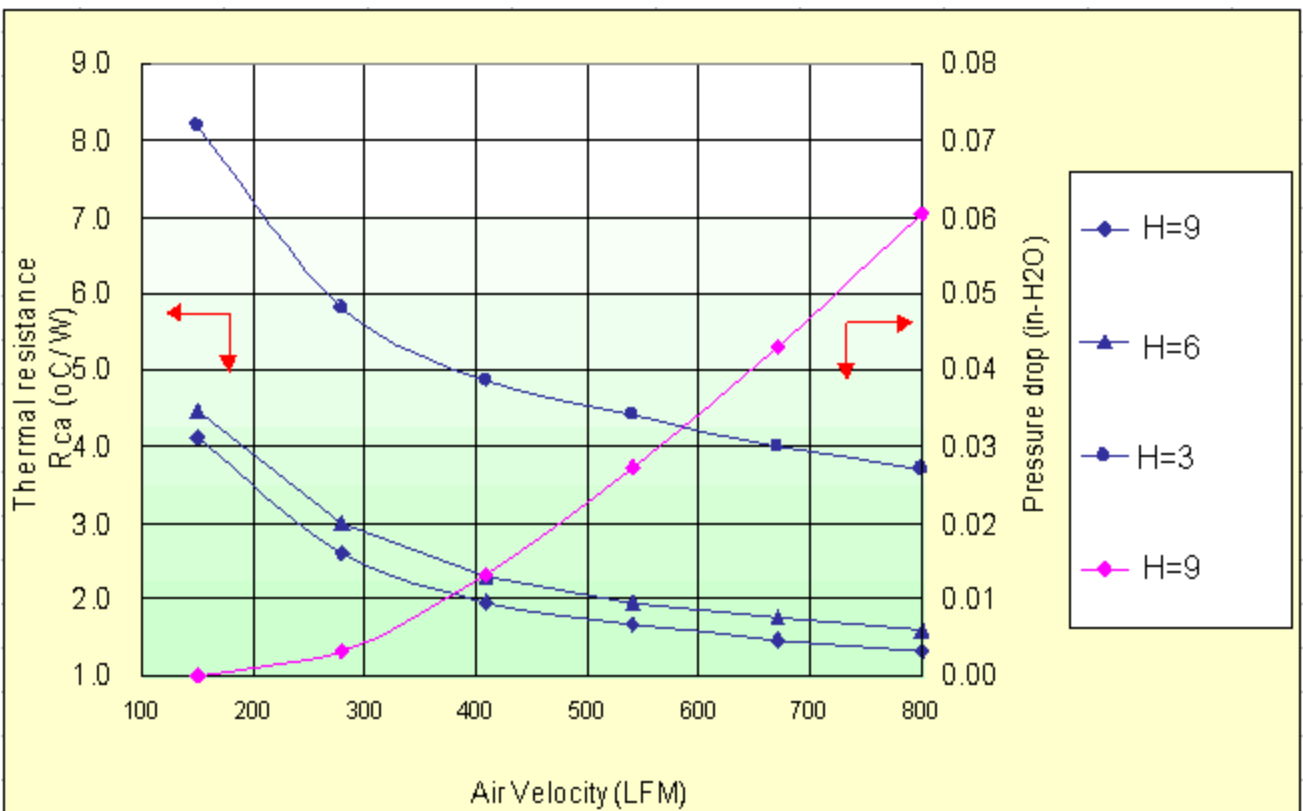

Model : LT37001-XX20ZA



Heat Sink



Specification

- 1. Material : Al 1070
- 2. Dimension :
 - Foot print : 37.1 x 37.1mm
 - Height : 9、6、3 mm
 - Base (thickness) : 2.0mm

- 3. Finish: Black Anodize

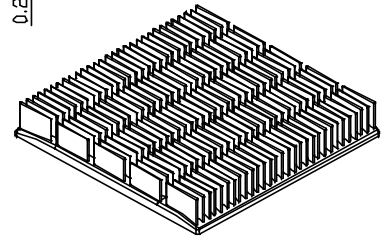
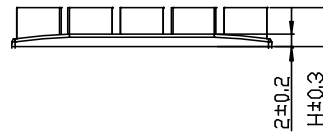
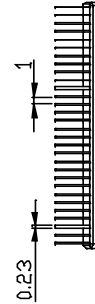
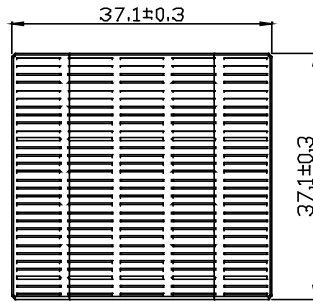

Performance

Heat Source (LxW)	12x12
-------------------	-------

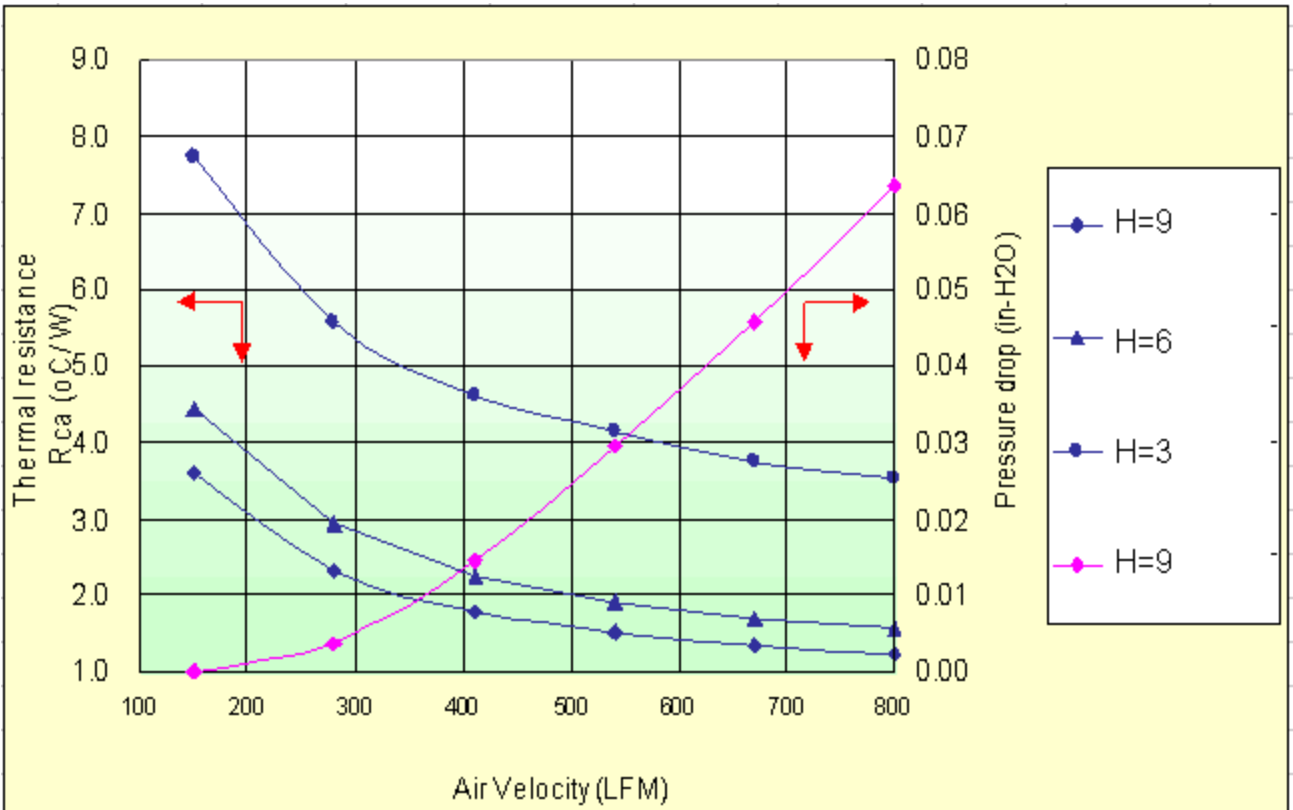

Model : LT40001-XX20ZA



Heat Sink



Specification

- 1. Material : Al 1070
- 2. Dimension :
 - Foot print : 40 x 40mm
 - Height : 9、6、3mm
 - Base (thickness) : 2.0mm

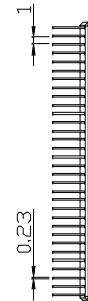
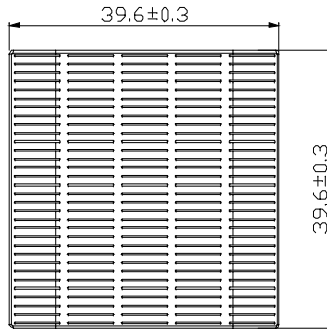

- 3. Finish: Black Anodize

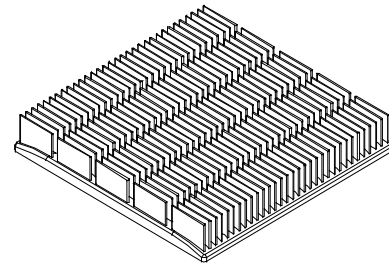
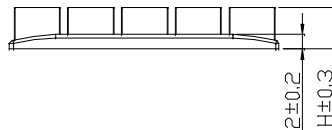

Performance

Heat Source (LxW)	12x12
-------------------	-------

